



# PARK

BERTI SPARE PARTS REFERENCE GUIDE

---



Mod. PARK/P

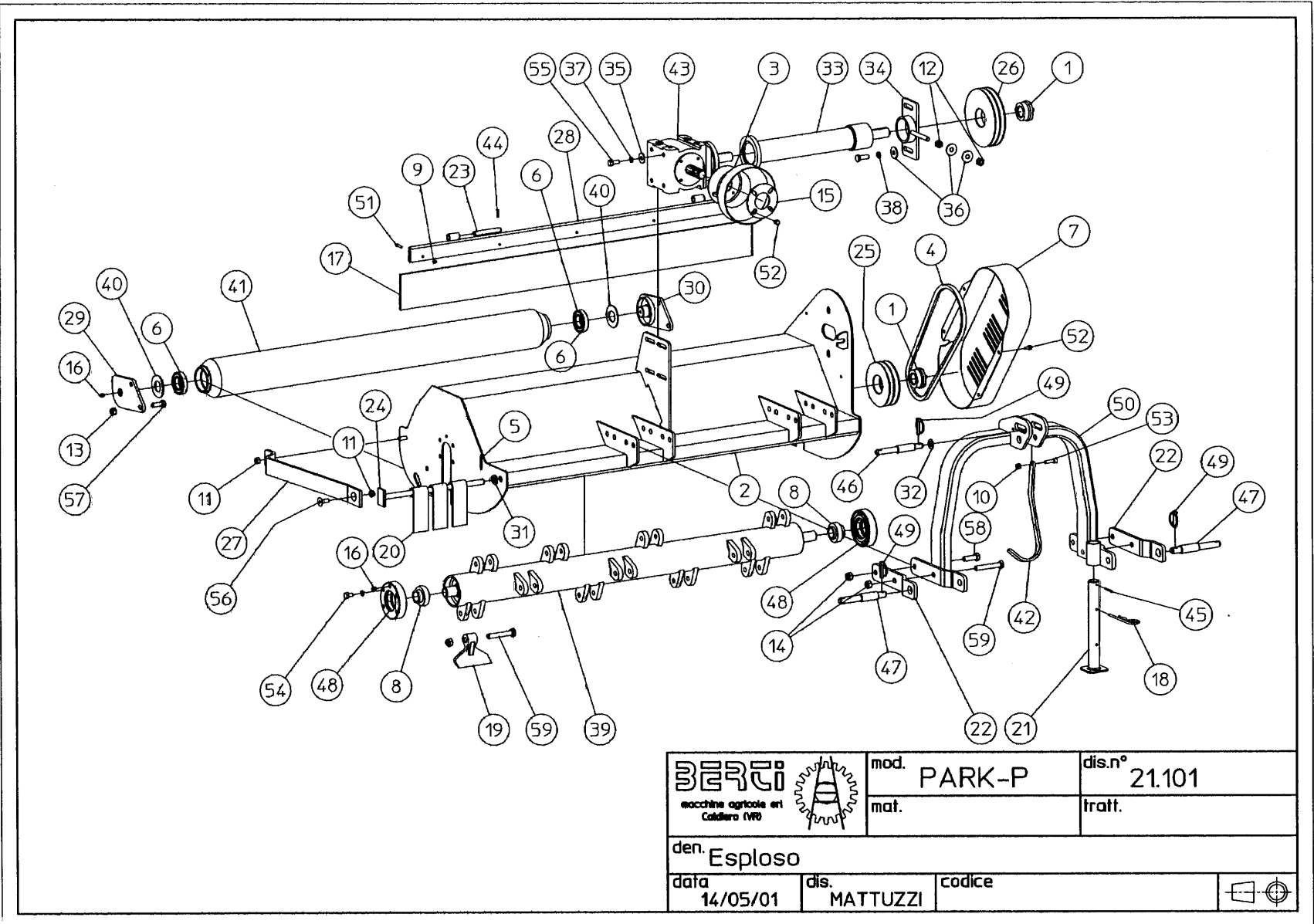

Exploded codes:

Mod. PARK/P

fig. 21.101

BERTI MACCHINE AGRICOLE srl

Pos.	ITEM	PARK/P 105	PARK/P 115	PARK/P 125	PARK/P 145	PARK/P 160		
1	CENTER LOCK 35x65	CA3565	CA3565	CA3565	CA3565	CA3565		
2	CENTRAL BODY	CC105/1447	CC115/1447	CC125/1447	CC145/1447	CC165/1447		
3	UNIV. JOINT HOUSING	CC004	CC004	CC004	CC004	CC004		
4	BELT	CISPB1250	CISPB1250	CISPB1250	CISPB1250	CISPB1250		
5	SPLIT PIN	CF032070	CF032070	CF032070	CF032070	CF032070		
6	BEARING	CRS06208Z	CRS06208Z	CRS06208Z	CRS06208Z	CRS06208Z		
7	PULLEYS COVER	CT/0818	CT/0818	CT/0818	CT/0818	CT/0818		
8	BEARING	CYYAR2072F	CYYAR2072F	CYYAR2072F	CYYAR2072F	CYYAR2072F		
9	NUT	DE06AL6SPGZ	DE06AL6SPGZ	DE06AL6SPGZ	DE06AL6SPGZ	DE06AL6SPGZ		
10	SELF-LOCKING NUT	DE10AL6SPGZAB	DE10AL6SPGZAB	DE10AL6SPGZAB	DE10AL6SPGZAB	DE10AL6SPGZAB		
11	SELF-LOCKING NUT	DE12AL6SPGZAB	DE12AL6SPGZAB	DE12AL6SPGZAB	DE12AL6SPGZAB	DE12AL6SPGZAB		
12	NUT	DE14AL6SPGN	DE14AL6SPGN	DE14AL6SPGN	DE14AL6SPGN	DE14AL6SPGN		
13	SELF-LOCKING NUT	DE14AL6SPGZAB	DE14AL6SPGZAB	DE14AL6SPGZAB	DE14AL6SPGZAB	DE14AL6SPGZAB		
14	SELF LOCKING NUT	DE16AL6SPGZAB	DE16AL6SPGZAB	DE16AL6SPGZAB	DE16AL6SPGZAB	DE16AL6SPGZAB		
15	FLANGE	FR/1338	FR/1338	FR/1338	FR/1338	FR/1338		
16	GREASER M10X1	IN101XXDR	IN101XXDR	IN101XXDR	IN101XXDR	IN101XXDR		
17	RUBBER PLATE	LT06130L1050	LT06130L1150	LT06130L1250	LT06130L1450	LT06130L1600		
18	FOOT SPRING	MF070550205Z	MF070550205Z	MF070550205Z	MF070550205Z	MF070550205Z		
19	"L" HAMMER	ML/0007	ML/0007	ML/0007	ML/0007	ML/0007		
20	FLAP	PA05/0011	PA05/0011	PA05/0011	PA05/0011	PA05/0011		
21	FOOT	PA38305	PA38305	PA38305	PA38305	PA38305		
22	ATTACHMENT PLATE	PAP012F29/0460	PAP012F29/0460	PAP012F29/0460	PAP012F29/0460	PAP012F29/0460		
23	HINGE PIVOT	PE0150110	PE0150110	PE0150110	PE0150110	PE0150110		
24	FLAPS BAR	PE0180980	PE0181080	PE0181280	PE0181480	PE0181630		
25**	PULLEY	PG150G2V	PG150G2V	PG150G2V	PG150G2V	PG150G2V		
26**	PULLEY	PG200G2V	PG200G2V	PG200G2V	PG200G2V	PG200G2V		
27	SIDE PROTECTION	PL100600	PL100600	PL100600	PL100600	PL100600		
28	RUBBER PLATE SUPPORT	SP040970	SP041070	SP041170	SP041370	SP041520		
29	ROLLER BRACKET RH	PR139DX/1291	PR139DX/1291	PR139DX/1291	PR139DX/1291	PR139DX/1291		
30	ROLLER BRACKET LH	PRI39SX/1291	PRI39SX/1291	PRI39SX/1291	PRI39SX/1291	PRI39SX/1291		
31	WASHER Ø18	RP18XXFN	RP18XXFN	RP18XXFN	RP18XXFN	RP18XXFN		
32	WASHER Ø18	RP18XXFZ	RP18XXFZ	RP18XXFZ	RP18XXFZ	RP18XXFZ		
33	EXTENSION	*	*	*	*	*		
34	BELT-TIGHTENING DEVICE	PT08/1777	PT08/1777	PT08/1777	PT08/1777	PT08/1777		
35	WASHER Ø12x36	RF1236FN	RF1236FN	RF1236FN	RF1236FN	RF1236FN		
36	WASHER Ø14x42	RF1442FN	RF1442FN	RF1442FN	RF1442FN	RF1442FN		
37	GROVER WASHER Ø12	RG12XXARN	RG12XXARN	RG12XXARN	RG12XXARN	RG12XXARN		
38	GROVER WASHER Ø14	RG14XXARN	RG14XXARN	RG14XXARN	RG14XXARN	RG14XXARN		
39	ROTOR	RC114105P	RC114115P	RC114125P	RC114145P	RC114160P		
40	ROLLER PROTECTION	RP4080	RP4080	RP4080	RP4080	RP4080		
41	LEVELLING ROLLER	RL105/1293	RL115/1293	RL125/1293	RL145/1293	RL160/1293		
42	UNIV. JOINT SUPPORT	SC/0352	SC/0352	SC/0352	SC/0352	SC/0352		
43	GEAR BOX	*	*	*	*	*		

